

SUNLITE® (10mm) - Installation Instructions



10mm Twin Wall Sheet

Rafter and Purlin Nominal Spacing (mm)

Sheet Thickness	Sheet width	Rafter Centers	Purlin Centers
10mm	980	1000	1200

Notes

- ⦿ Carefully read all installation instructions before you start.
- ⦿ Always exercise extreme care when working on a roof.
- ⦿ Never walk directly on the sheeting, use walking boards along purlins.
- ⦿ Always wear eye protection when using cutting tool.
- ⦿ For safety precautions Palram recommends the use of safety mesh for installations above 3m height.

Installation Steps

1. Always install Sunlite sheets with the ribs running vertically with the direction of the fall.

2. Make sure there is adequate fall of minimum 5 degrees (87mm per 1000mm) Good fall will aid in keeping the sheets clean.

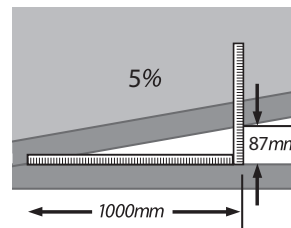

3. Cut H Joiner alum profiles to size.

4. Always cut SUNLITE® panels **40mm** longer than alum glazing bars. SUNLITE® sheets can be cut with standard wood or metal saw with fine tooth blade. Saw blades designed especially for plastic yield best results. If SUNLITE® width need to be reduced, trim as close as possible to the last rib to obtain better clamping action.

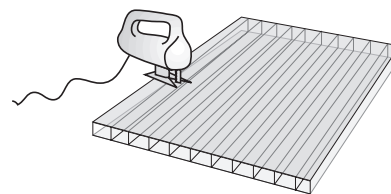

5. Place the first and second H Joiner base profile on the structure. The maximum allowed end overhang is 50mm.

6. If installing on rafters only, fasten the H Joiner Base Profile, through it's center, to the structure by using 10 gauge 16tpi screws at intervals no greater than 500mm. If fitting to purlins, fix base at intervals of max 1200mm.

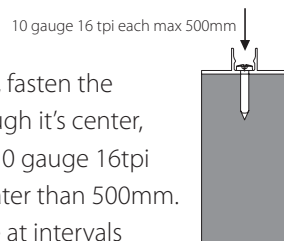

7. Cut to size the foam gasket and bond it to the H Joiner Base Profile. Make sure the edges of the foam and the base profile are aligned.



8. Pull the protective film back on the side of the sheet and place the sheet between the two secured H Joiner Base Profiles. Sheeting should overhang 20mm from each end.

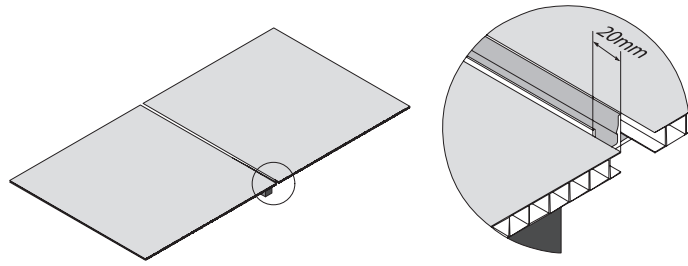

9. Cut to size and insert the Captive wedge gasket into the H joiner Cover profile. Make sure the cover profile and the captive wedge are aligned. Position the first H Joiner Cover aligned with the first H Joiner Base and secure the two profiles by using rubber mallet.

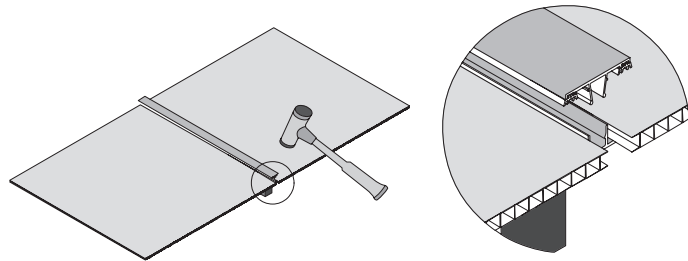

10. Repeat steps 6-10 until all sheets are positioned.

11. Insert the Alum End Cap on the bottom sheet end. Do not stop at glazing bars. Make sure to join alum sheet end caps at the alum joiner so that the joint is covered by the alum end cap lock.

12. Secure the Alum end Cap by screw fastening the Alum End Cap Lock to the H Joiner Cover. This will prevent End Cap from falling off due to sheet expansion.

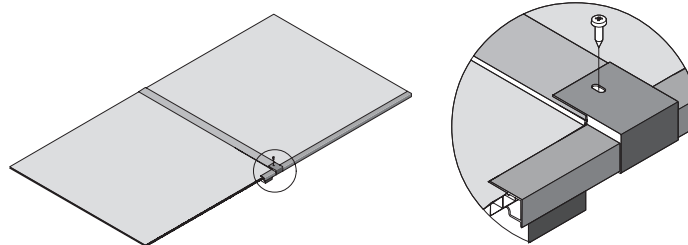

70851 - 05.10

Inasmuch as PALRAM Industries has no control over the use to which others may put the material, it does not guarantee that the same results as those described herein will be obtained. Each user of the material should make his own tests to determine the material's suitability for his own particular use. Statements concerning possible or suggested uses of the materials described herein are not to be construed as constituting a license under any PALRAM Industries patent covering such use or as recommendations for use of such materials in the infringement of any patent. PALRAM Industries or its distributors cannot be held responsible for any losses incurred through incorrect installation of the material. In accordance with our company policy of continual product development you are advised to check with your local PALRAM Industries supplier to ensure that you have obtained the most up to date information.



PALRAM Australia Branches

PALRAM SA / NT
517a Cross Keys Rd
Cavan SA 5094
Ph: +61 8 8262 2288

PALRAM WA
60 Boulder Rd
Malaga WA 6090
Ph: +61 8 9249 4711

PALRAM NSW
196 Newton Rd
Wetherill Park NSW 2164
Ph: +61 2 9757 3166

PALRAM QLD
80 Oxley Rd
Chelmer QLD 4068
Ph: +61 7 3379 5155

PALRAM VIC / TAS
34b Randor St
Campbellfield VIC 3061
Ph: +61 3 9357 9240

www.palram.com.au

©1998 PALRAM Industries Ltd.
SUNLITE is a registered trademark of PALRAM Industries Ltd.